

COMPOST FILTER SOCK
N.T.S.

LOCUS
N.T.S.

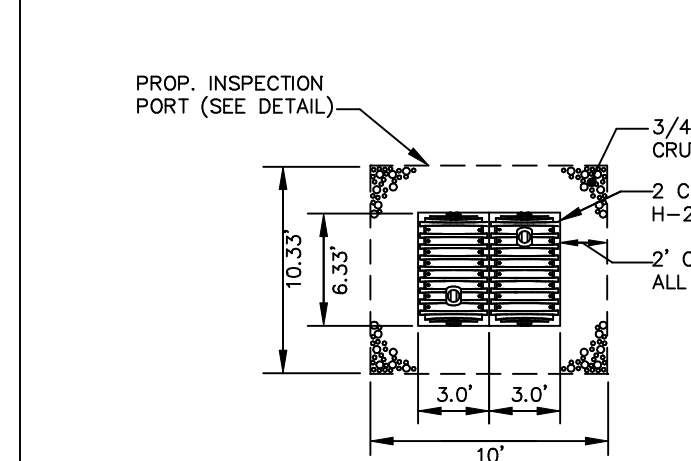

ROOF INFILTRATION SYSTEM (2 CHAMBERS)
N.T.S.

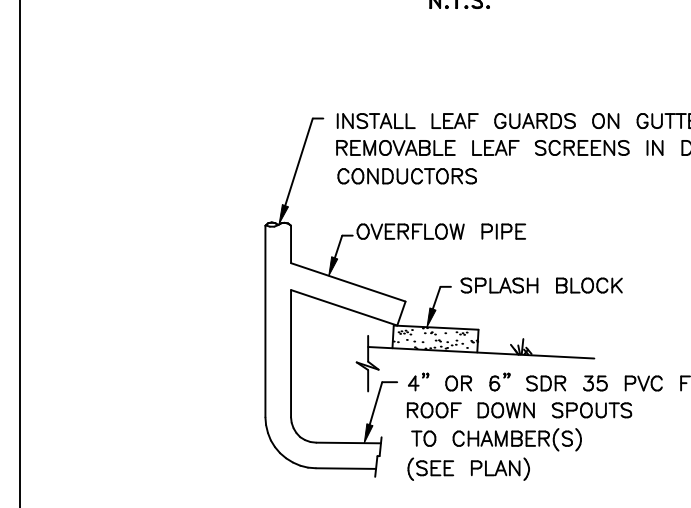

ROOF LEADER DETAIL
N.T.S.

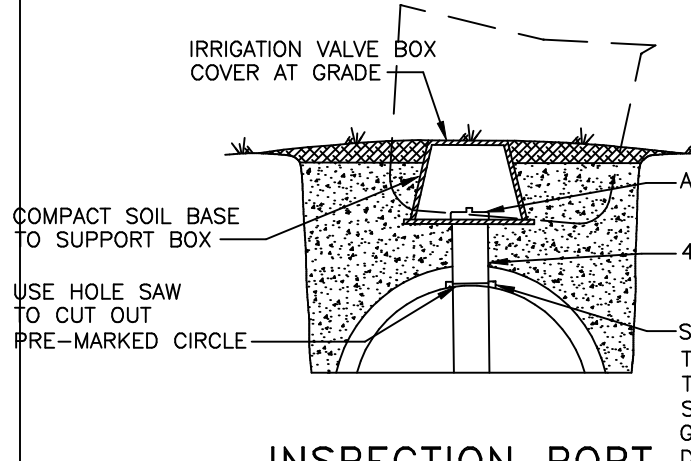

INSPECTION PORT TYPICAL INSTALLATION DETAIL
N.T.S.

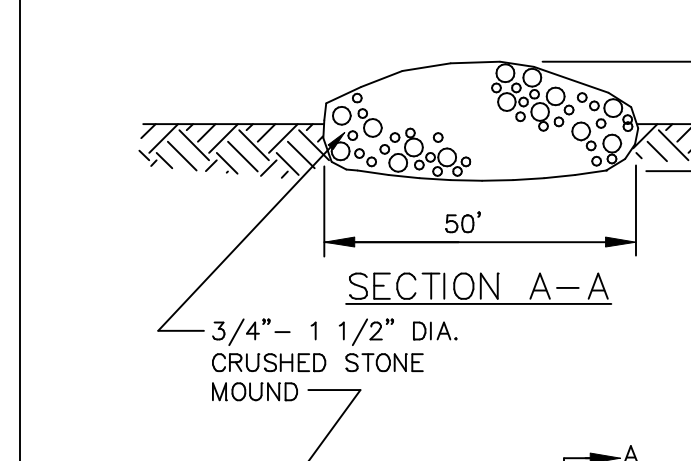

STABILIZED CONSTRUCTION ENTRANCE
N.T.S.

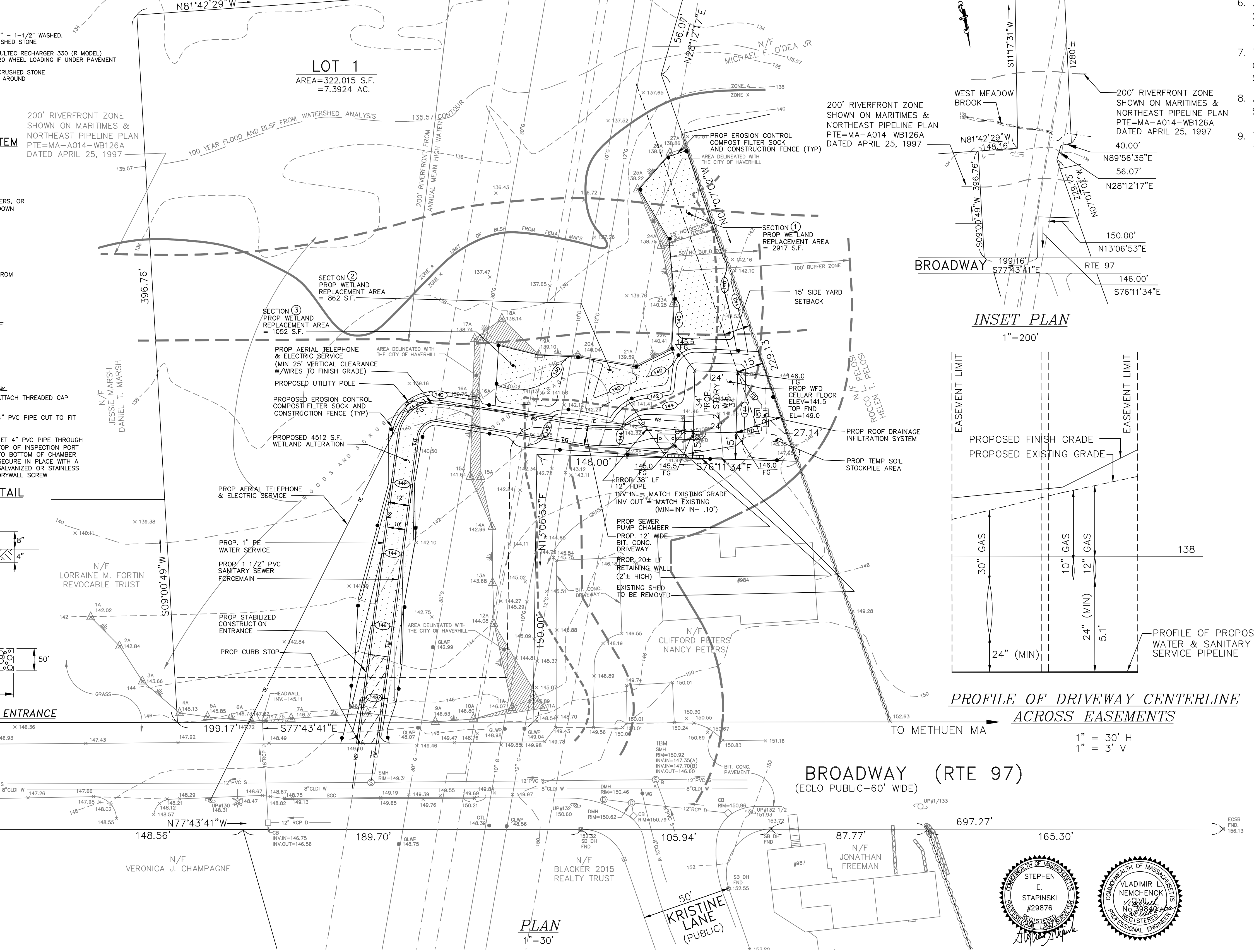

PLAN
1"=30'

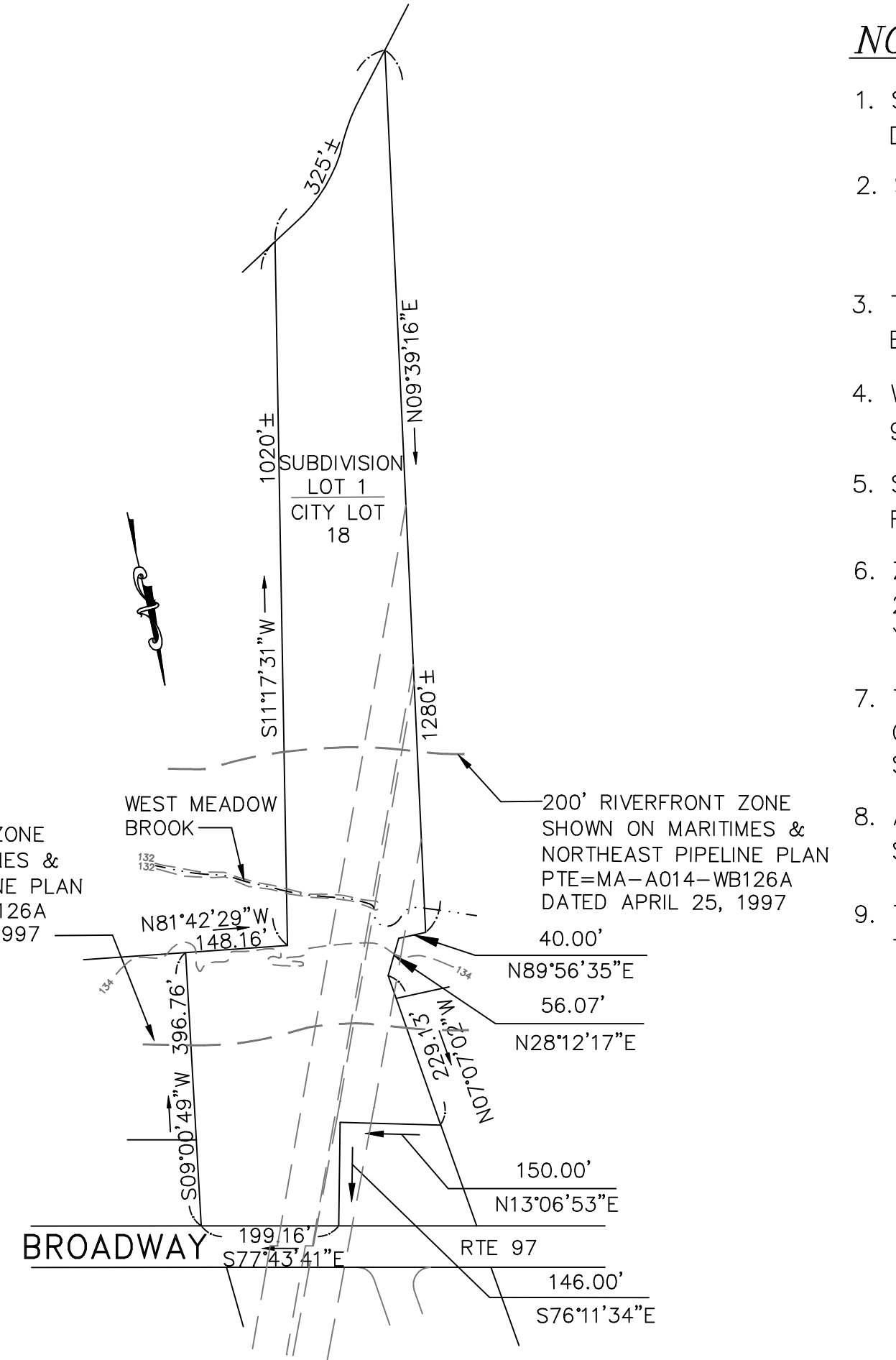

INSET PLAN
1"=200'

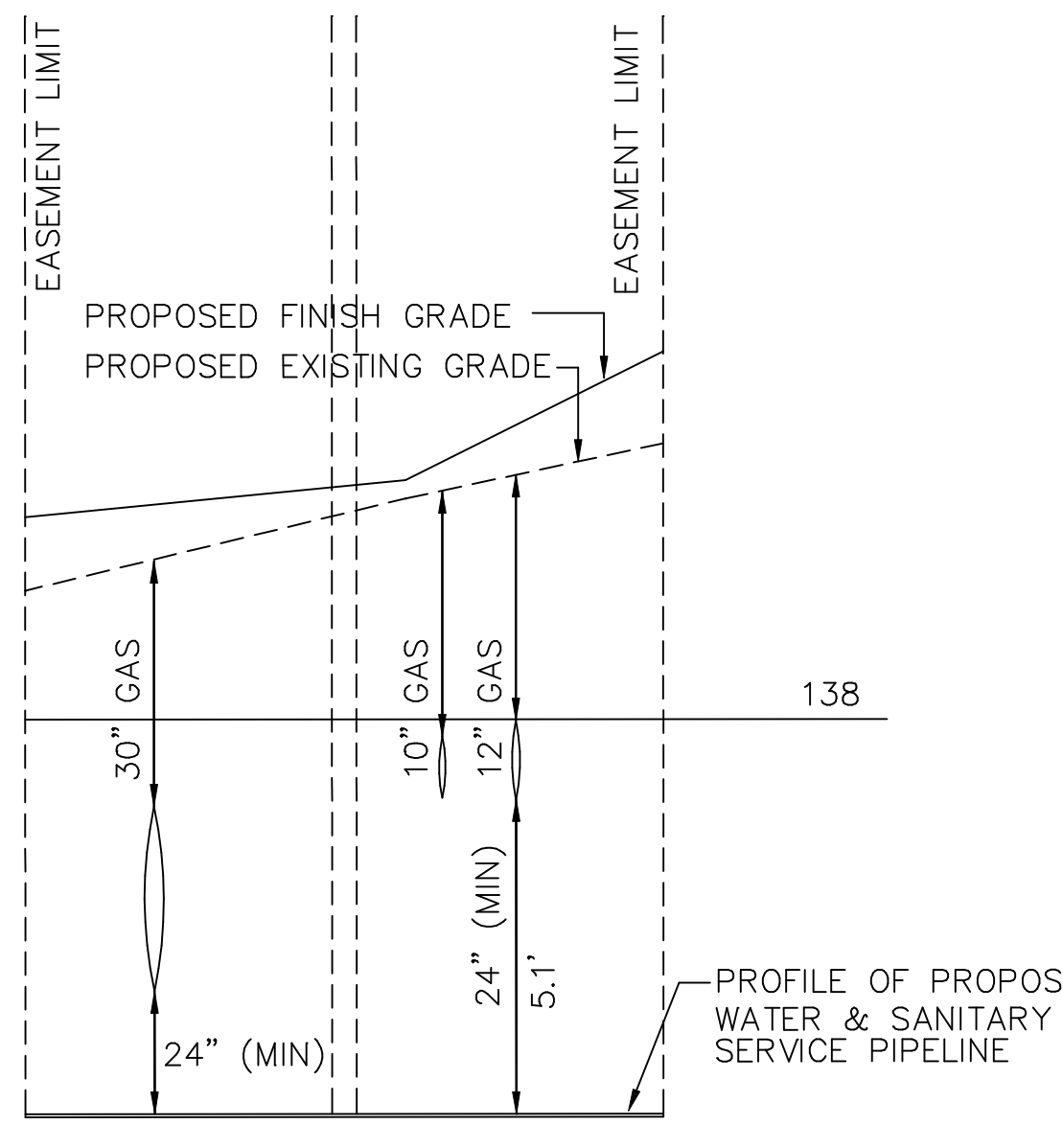

PROFILE OF DRIVEWAY CENTERLINE ACROSS EASEMENTS
1"=30' H
1"=3' V

NOTES

- SEE CITY OF HAVERHILL ASSESSORS MAP 539 BLOCK 439 LOT 18 AND DEED BOOK 35365 PAGE 422 E.S.D.R.D. FOR SITE.
- SEE THE FOLLOWING E.S.D.R.D. REFERENCES:
PLAN BOOK 194 PLAN 75
E.C.L.O. 2774
- TOPOGRAPHIC DATUM BASE IS 1988 N.A.V.D. ESTABLISHED BY G.P.S. BENCHMARK IS SEWER MANHOLE RIM LOCATED ON BROADWAY, EL.=150.92.
- WETLANDS DELINEATED BY NORSE ENVIRONMENTAL SERVICES, 92 MIDDLESEX RD., UNIT 4, TYNGSBORO, MA.
- SITE IS LOCATED IN AN ESTABLISHED 100 YEAR FLOODPLAIN PER FEMA COMMUNITY PANEL NO. 25009C0067F DATED JULY 3, 2012.
- ZONE DISTRICT IS RM, REQUIRES 20,000 S.F. LOT AREA, 150' FRONTAGE, 25' FRONT YARD SETBACK, 15' SIDE YARD SETBACK AND 30' REAR YARD SETBACK.
- TENNESSEE GAS COMPANY PIPELINE MARKED IN FIELD 5/20/20 BY GAS COMPANY AND FIELD LOCATED 5/22/20 BY MERRIMACK ENGINEERING SERVICES.
- ALL WORK SHALL CONFORM TO CITY OF HAVERHILL WATER DEPT & DPW STANDARDS. ALL NON PAVED AREAS TO BE LOAM & SEED.
- TOTAL WETLAND ALTERATION = 4512 S.F.;
TOTAL WETLAND REPLACEMENT = 4831 S.F.

LEGEND

- SB DH STONE BOUND DRILL HOLE
- ⊙ DMH DRAIN MANHOLE
- ⊙ SMH SEWER MANHOLE
- CB CATCH BASIN
- WG WATER GATE
- GLWP GAS LINE WARNING POST
- ⊙ UP UTILITY POLE
- ⊙ HYDRANT
- X 142.12 SPOT ELEVATION
- 142--- ELEVATION CONTOUR
- S — SEWER PIPELINE
- D — DRAIN PIPELINE
- W — WATER PIPELINE
- G — GAS PIPELINE
- C — STONE WALL
- RCP REINFORCED CONCRETE PIPE
- SGC SLOPED GRANITE CURB
- N/F NOW OR FORMERLY
- FND FOUND
- W.F. WOOD FRAME
- STY. STORY
- CEM. CONC. CEMENT CONCRETE
- BIT. CONC. BITUMINOUS CONCRETE
- PVC POLYVINYL CHLORIDE
- CLDI CEMENT LINED DUCTILE IRON
- BLSF BORDERING LAND SUBJECT TO FLOODING
- WS — WATER SERVICE
- FM — SEWER FORCE MAIN
- SS — SANITARY SEWER
- RD — ROOF DRAIN
- PROP PROPOSED
- TEMP TEMPORARY
- INV INVERT

SITE PLAN
LAND IN
HAVERHILL, MASSACHUSETTS

PREPARED FOR
ANTONIO VIOLA
80 MAIN STREET
MALDEN, MASSACHUSETTS 02148
DATE: JULY 29, 2020

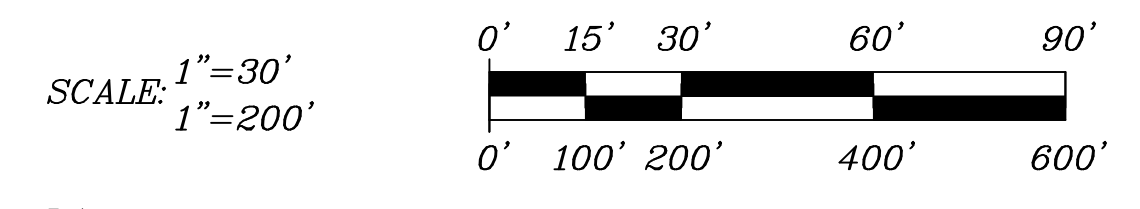

MERRIMACK ENGINEERING SERVICES
66 PARK STREET
ANDOVER, MASSACHUSETTS 01810
PHONE: (978) 475-3555 FAX: (978) 475-1448
EMAIL: MERRENG@AOL.COM

